

HARRY POTTER ESCAPE ROOM ALACHUA COUNTY LIBRARY DISTRICT

YEW & PHOENIX
FEATHER
THIRTEEN & A HALF INCHES BENDY.



Why we chose a Harry Potter themed rooms.

- Recycling the abundance of Harry Potter items we already had.
- Huge fan base

Four smaller rooms vs. One larger room

- Less pressure for staff
- More patrons
- Varying difficulty of rooms

	Time Slot #1			
	Quidditch Supply Store	Flourish & Blotts Bookstore	Ollivander's Wand Store	Gringotts Wizard Bank
1				
2				
3				
4				
5				
6				
7				
8				



Serving all ages

- Family groups
- Difficulty of clues
- Fun, fun, fun!



Setting the stage: Diagon alley

- We welcomed guests, read the script, and divided them into 4 groups to search the 4 different rooms
- Their mission is to retrieve their wands before being captured by the Death Eaters.
- Rooms: Flourish & Blotts Bookstore, Ollivanders Wands, Quiditch Supply Store, and Gringott's Bank.



Deposit/Withdrawal Ticket	GRINGOTT'S BANK 
	<small>The safest place for everything valuable</small>
DATE: <input type="text"/>	
ACCOUNT: <input type="text"/>	
ACCOUNT NAME: <input type="text"/>	
ACCOUNT NUMBER: <input type="text"/>	
	<small>Withdrawals are not recommended</small>
676424325: 2277 - 36837 - 0677	

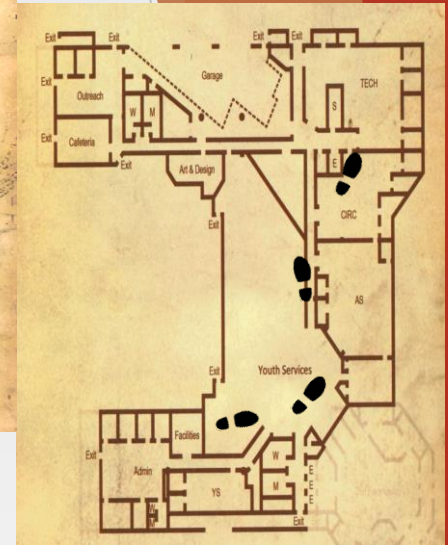
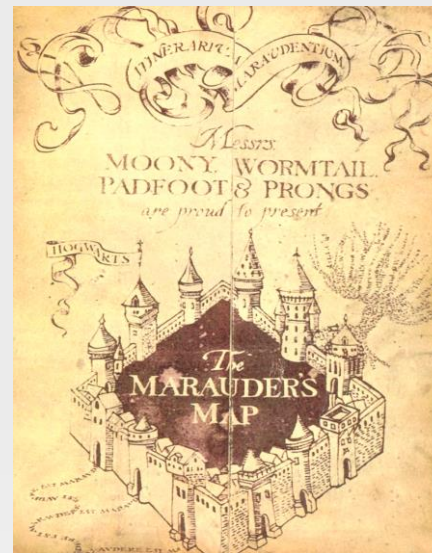

• Rules

- Thirty minutes to complete your room.
- Participants can ask for help but will deduct from time.
- Cannot damage anything.
- Must stay within the space allowed.

